



NAU  
HOTELS & RESORTS



Leading Guest Happiness

[www.nauhotels.com](http://www.nauhotels.com)



NAU Hotels & Resorts currently has  
**10 Hotels of 4 and 5-star,**  
**3 Golf Courses of 18 holes**  
**and 2 Congress Centres**  
 in PORTUGAL



 <b>LISBON</b>		
PALÁCIO DO GOVERNADOR * * * * *		Historic Center of Belém
 <b>ALENTEJO</b>		
LAGO MONTARGIL & VILLAS * * * * *		Montargil
 <b>ALGARVE</b>		
SALEMA BEACH VILLAGE * * * * *		Vila do Bispo
SÃO RAFAEL SUITES * * * * *		Albufeira
SÃO RAFAEL ATLÂNTICO * * * * *		Albufeira
SALGADOS DUNAS SUITES * * * * *		Albufeira
SALGADOS PALACE * * * * *		Albufeira
SALGADOS PALM VILLAGE APARTMENTS & SUITES * * * * *		Albufeira
SALGADOS VILA DAS LAGOAS APARTMENTS * * * * *		Albufeira
MORGADO GOLF & COUNTRY CLUB * * * * *		Portimão
MORGADO GOLF COURSE	18 Holes   Par 73	Portimão
ÁLAMOS GOLF COURSE	18 Holes   Par 71	Portimão
SALGADOS GOLF COURSE	18 Holes   Par 72	Albufeira
ALGARVE CONGRESS PALACE		Albufeira
SÃO RAFAEL ATLÂNTICO CONGRESS CENTER		Albufeira



### VILA DO BISPO

#### SALEMA BEACH

- Salema Beach Village \* \* \* \*

### PORTIMÃO

#### MORGADO GOLF RESORT

- Morgado Golf & Country Club \* \* \* \*
- Morgado Golf Course - 18 holes
- Álamos Golf Course - 18 holes

### ALBUFEIRA

#### SALGADOS RESORT

- Salgados Palace \* \* \* \* \*
- Algarve Congress Palace
- Salgados Dunas Suites \* \* \* \* \*
- Salgados Palm Village Apartments & Suites \* \* \* \*
- Salgados Vila das Lagoas Apartments \* \* \* \*
- Salgados Golf Course - 18 holes

#### SÃO RAFAEL BEACH

- São Rafael Atlântico \* \* \* \* \*
- São Rafael Atlântico Congress Center
- São Rafael Suites \* \* \* \* \*





# HERDADE DOS SALGADOS RESORT



- ALGARVE CONGRESS PALACE
- SALGADOS BEACH
- SALGADOS GOLF COURSE (18 holes)
- ALGARVE INTERNATIONAL AUTODROME: 41,8 km
- ALBUFEIRA CITY CENTER: 7 km
- ALBUFEIRA MARINA: 6,4 km
- ZOOMARINE: 7 km
- FARO AIRPORT: 49 km





NAU

HOTELS & RESORTS

---

SALGADOS PALACE  
& CONGRESS CENTER



ALGARVE



GREAT HOTELS  
OF THE WORLD



**ALGARVE**

ALBUFEIRA - PORTUGAL

[www.nauhotels.com](http://www.nauhotels.com)





## SALGADOS PALACE & CONGRESS CENTER

★ ★ ★ ★ ★  
ALGARVE

- 228 Accommodation units, including 12 Deluxe Suites and 1 Presidential Suite
- SPA with Gym
- 4 Outdoor Pools (2 for children)
- 3 Restaurants
- 4 Bars
- Free covered and outdoor parking
- Free Wi-Fi
- Tennis and Football court of 5 (synthetic grass)
- Algarve Congress Palace auditorium with 1650 seats and up to 23 rooms



**ALGARVE**  
ALBUFEIRA - PORTUGAL

[www.nauhotels.com](http://www.nauhotels.com)





## SALGADOS PALACE & CONGRESS CENTER

★ ★ ★ ★ ★  
ALGARVE

- **“GOLF LOBBY BAR”**  
capacity up to 90 seats in the room  
and 40 in the terrace
- **“19<sup>TH</sup> HOLE ” – POOL SNACK BAR**  
capacity up to 50 seats in the room  
and 200 in the terrace
- **“MOONLIGHT” RESTAURANT**  
capacity up to 90 seats
- **“ALL IN ONE” RESTAURANT**  
capacity up to 420 seats extendable up to 850 people
- **INTERIOR SPACE**  
capacity to serve up to 1600 people seated
- **MULTIFUNCTIONAL MEETING ROOM**  
capacity up to 850 seats in banquet setup



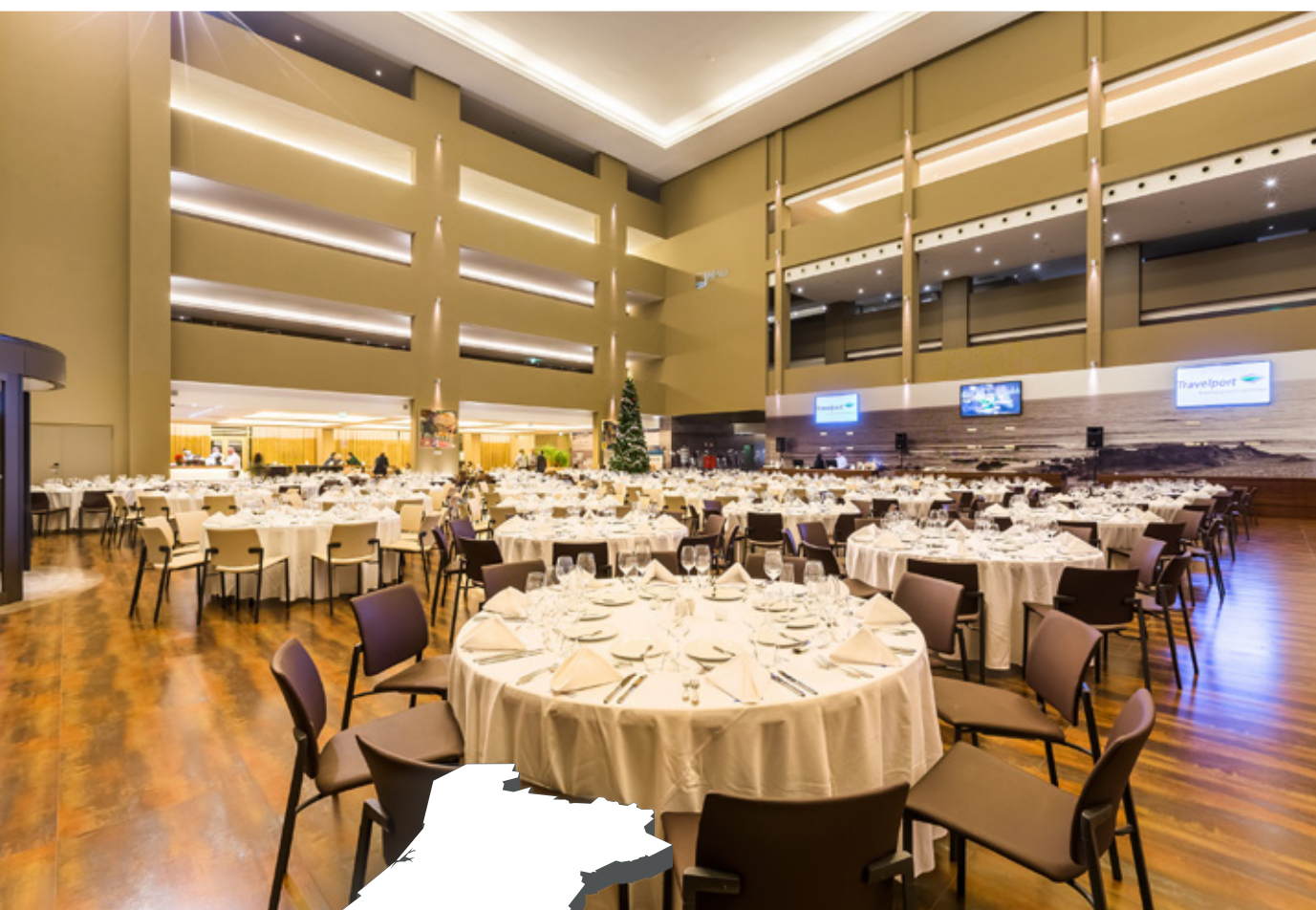

## SALGADOS PALACE & CONGRESS CENTER

★ ★ ★ ★ ★  
ALGARVE

At the **hotel Salgados Palace** you find **Algarve's largest Congress Centre** and **one of the largest in the Iberian Peninsula**. This fantastic facility is equipped with cutting-edge technology, offering unique conditions to accomplish all kinds of events, whether they are meeting, conventions, product launches, conferences or other incentives.

Its features include:

- **Auditorium** with extendable capacity between 500 and 1.650 seats, equipped with the latest technology and 4 simultaneous translations booths
- **Flat multifunction room** with more than 1096 m<sup>2</sup> adaptable to receive all kinds of events with capacity up to 850 people at banquet
- **23 multifunctional meeting rooms**, spread across the 4 floors
- Air conditioning
- Free Wi-Fi
- Outdoor venues for events

**ALGARVE**  
ALBUFEIRA - PORTUGAL

[www.nauhotels.com](http://www.nauhotels.com)



# Floor 0

## SALGADOS PALACE & CONGRESS CENTER

★★★★★  
ALGARVE



### ROOMS

	DIMENSIONS (LxWxH)	AREA	THEATER	SCHOOL	U	CABARET	BANQUET	COCKTAIL	BUFFET
<b>SILVES — multifunctional room <sup>NL/1</sup></b>	16 x 22 x 3	349 m <sup>2</sup>	300	200	—	189	270	400	220
<b>Silves I <sup>NL</sup></b>	8 x 7 x 3	55 m <sup>2</sup>	32	24	20	28	40	40	30
<b>Silves II</b>	8 x 8 x 3	64 m <sup>2</sup>	46	24	23	35	50	60	30
<b>Silves III</b>	8 x 7 x 3	56 m <sup>2</sup>	32	24	20	28	40	40	30
<b>Silves VI</b>	7 x 7 x 3	54 m <sup>2</sup>	32	24	20	28	40	40	30
<b>Silves IV* + I <sup>NL</sup></b>	16 x 7 x 3	111 m <sup>2</sup>	84	48	42	56	80	90	60
<b>Silves V* + II</b>	16 x 8 x 3	127 m <sup>2</sup>	84	48	42	56	80	90	60
<b>Silves VI + III</b>	16 x 7 x 3	127 m <sup>2</sup>	94	48	45	56	80	90	60
<b>Silves I + II + III <sup>NL</sup></b>	8 x 22 x 3	177 m <sup>2</sup>	130	72	60	84	120	140	90
<b>Silves IV* + V* + VI <sup>NL</sup></b>	7 x 22 x 3	174 m <sup>2</sup>	130	72	60	84	120	140	90
<b>ALBUFEIRA — multifunctional room <sup>1</sup></b>	7 x 18 x 3	148 m <sup>2</sup>	120	72	48	70	100	120	70
<b>Albufeira I</b>	7 x 5 x 3	45 m <sup>2</sup>	32	24	21	28	40	40	30
<b>Albufeira II</b>	7 x 5 x 3	46 m <sup>2</sup>	32	24	21	28	40	40	30
<b>Albufeira III</b>	7 x 6 x 3	55 m <sup>2</sup>	32	24	21	28	40	40	30
<b>LAGOS — multifunctional room <sup>1</sup></b>	7 x 18 x 3	142 m <sup>2</sup>	120	72	48	70	100	120	70
<b>Lagos I</b>	7 x 5 x 3	44 m <sup>2</sup>	32	24	21	28	40	40	30
<b>Lagos II</b>	7 x 5 x 3	44 m <sup>2</sup>	32	24	21	28	40	40	30
<b>Lagos III</b>	7 x 6 x 3	52 m <sup>2</sup>	32	24	21	28	40	40	30
<b>MONCHIQUE — multifunctional room</b>	13 x 16 x 3	239 m <sup>2</sup>	210	120	60	105	150	220	120
<b>PORTIMÃO — multifunctional room</b>	7 x 8 x 3	66 m <sup>2</sup>	50	30	21	42	60	70	40
<b>HALL (coffee-break) + FOYER</b>	— x — x 3	455 m <sup>2</sup>	—	—	—	—	—	200	200
<b>PRESS ROOM</b>	8 x 5 x 3	46 m <sup>2</sup>	50	30	21	35	50	60	30

Approximate dimensions/areas.

NL = with Natural Light. I 1 = See floor plan for possible layouts.

\* Rooms "Silves IV" and "Silves V" without entrance doors for independent use.

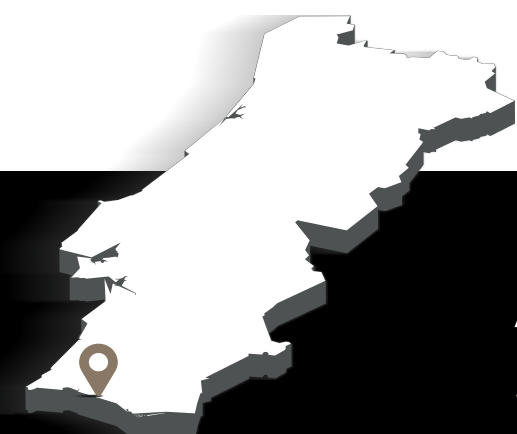



# Floor 1

## SALGADOS PALACE & CONGRESS CENTER

★★★★★  
ALGARVE

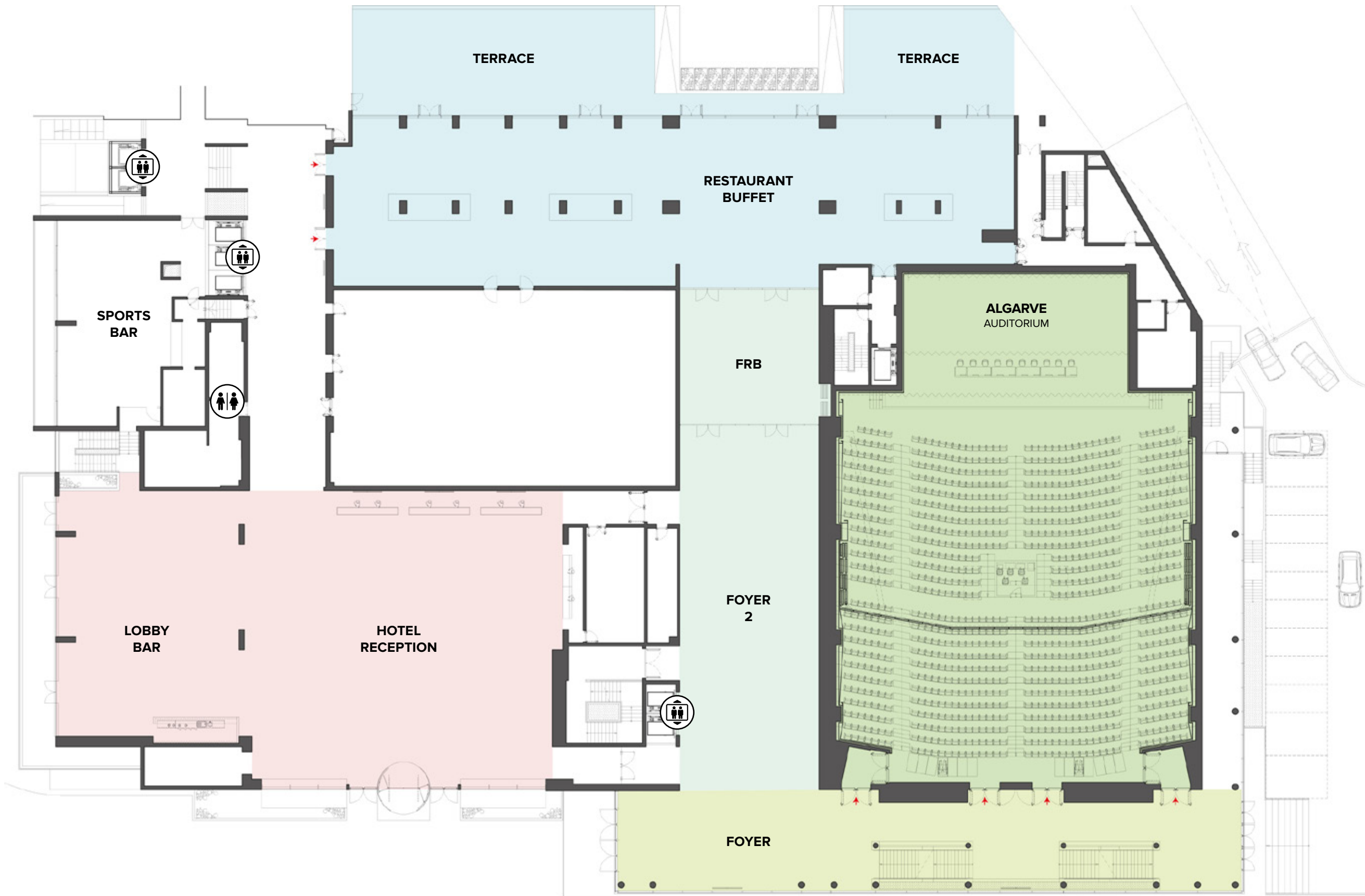

### ROOMS

	DIMENSIONS (LxWxH)	AREA	THEATER	SCHOOL	U	CABARET	BANQUET	COCKTAIL	BUFFET
FOYER <sup>NL</sup>	50 x 7 x 6 to 11	389 m <sup>2</sup>	—	—	—	—	—	200	—
FOYER 2 <sup>NL</sup>	26 x 11 x 3	294 m <sup>2</sup>	—	—	—	—	260	300	220
FOYER 2 + FRB <sup>NL</sup>	42 x 11 x 3	440 m <sup>2</sup>	—	—	—	—	380	450	330
BUFFET RESTAURANT <sup>NL/1</sup>	55 x 13 x 3	712 m <sup>2</sup>	—	—	—	—	450	1000	420
BUFFET RESTAURANT + FRB <sup>NL/1</sup>	—	857 m <sup>2</sup>	—	—	—	—	600	—	550
BUFFET RESTAURANT + FRB + FOYER 2 <sup>NL/1</sup>	—	1152 m <sup>2</sup>	—	—	—	—	900	—	850
TERRACE <sup>NL</sup>	—	374 m <sup>2</sup>	—	—	—	—	180	200	160
RECEPTION <sup>NL</sup> + LOBBY BAR <sup>NL</sup>	20 x 41 x —	870 m <sup>2</sup>	—	—	—	—	600	1000	500
BUFFET RESTAURANT + FOYER 2 + FRB + RECEPTION + LOBBY BAR <sup>NL/1</sup>	—	2022 m <sup>2</sup>	—	—	—	—	1600	2000	1300

Approximate dimensions/areas.

NL = with Natural Light. | 1 = See floor plan for possible layouts.





# Floor 2

## SALGADOS PALACE & CONGRESS CENTER

★★★★★  
ALGARVE



### ROOMS

	DIMENSIONS (LxWxH)	AREA	THEATER	SCHOOL	U	CABARET	BANQUET	COCKTAIL	BUFFET
FOYER <sup>NL</sup>	4 x 19 x 5	82 m <sup>2</sup>	—	—	—	—	120	150	100
HALL (Coffee-break) <sup>NL</sup>	8 x 11 x 5	89 m <sup>2</sup>	—	—	—	—	—	40	—
COFFEE-BREAK	9 x 9 x 5	89 m <sup>2</sup>	—	—	—	—	—	60	—
TAVIRA — multifunctional room	17 x 17 x 5	297 m <sup>2</sup>	270	150	72	140	200	250	150
FARO — multifunctional room <sup>NL</sup>	5 x 19 x 5	114 m <sup>2</sup>	144	60	57	49	70	130	50
Faro I	5 x 9 x 5	57 m <sup>2</sup>	64	30	24	35	50	60	30
Faro II <sup>NL</sup>	5 x 9 x 5	57 m <sup>2</sup>	64	30	24	35	50	60	30
VILA DO BISPO — support office <sup>INL</sup>	6 x 3 x 2	18 m <sup>2</sup>	12	9	9	—	—	—	—
CASTRO MARIM — support office <sup>INL</sup>	5 x 2 x 2	13 m <sup>2</sup>	12	9	9	—	—	—	—

Approximate dimensions/areas.  
**NL** = with Natural Light. **INL** = with Indirect Natural Light.





# Floor 4

## SALGADOS PALACE & CONGRESS CENTER

★★★★★  
ALGARVE

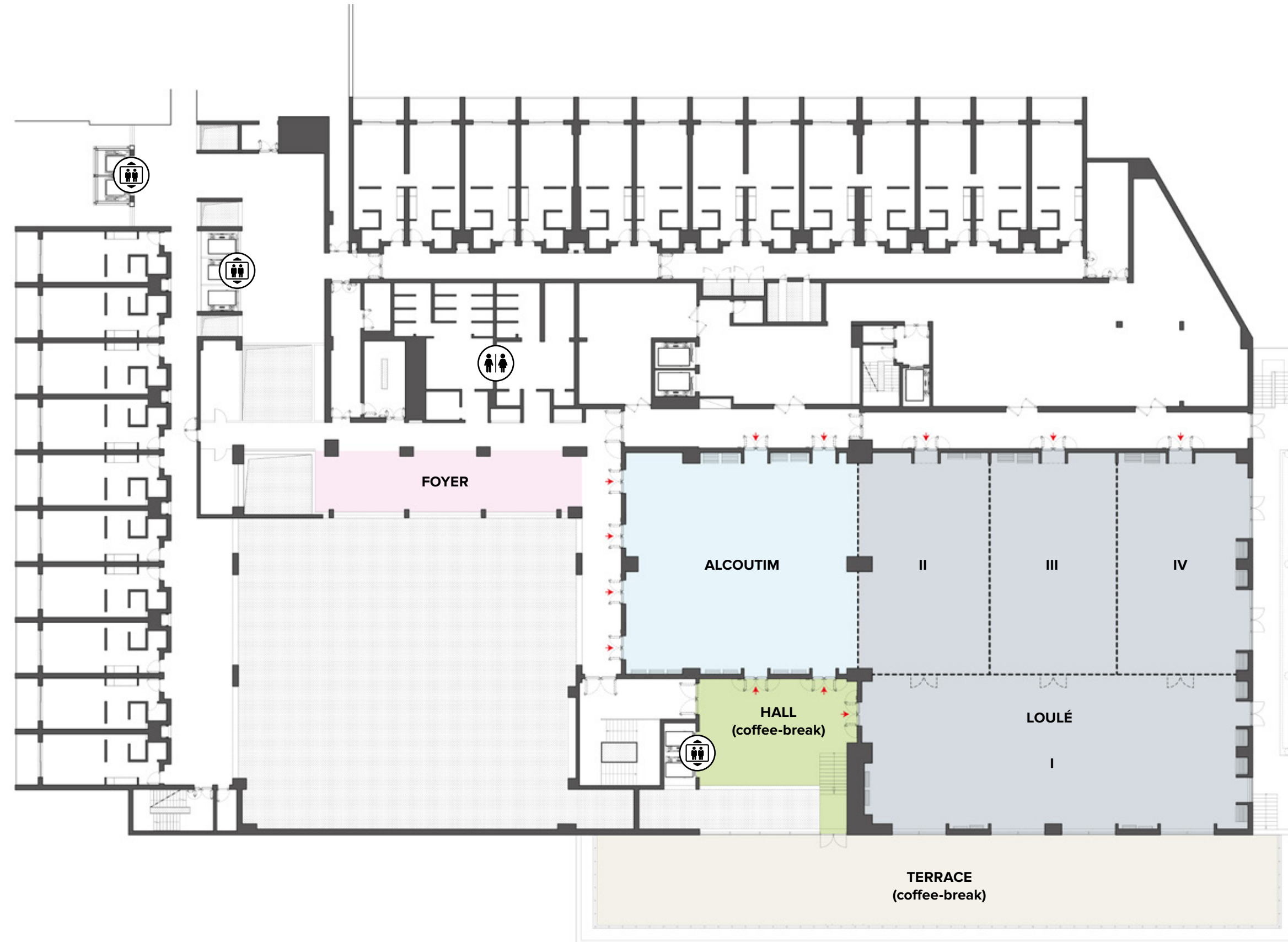

### ROOMS

	DIMENSIONS (LxWxH)	AREA	THEATER	SCHOOL	U	CABARET	BANQUET	COCKTAIL	BUFFET
FOYER <sup>NL</sup>	4 x 19 x 5	82 m <sup>2</sup>	—	—	—	—	120	150	100
HALL (coffee-break) <sup>NL</sup>	8 x 11 x 5	89 m <sup>2</sup>	—	—	—	—	—	40	—
LOULÉ — multifunctional room <sup>NL/1</sup>	27 x 28 x 5	807 m <sup>2</sup>	700	470	120	455	650	800	560
Loulé I <sup>NL</sup>	11 x 28 x 5	325 m <sup>2</sup>	320	180	93	147	210	250	180
Loulé II	16 x 9 x 5	160 m <sup>2</sup>	132	108	54	84	120	150	90
Loulé III	16 x 9 x 5	158 m <sup>2</sup>	132	108	54	84	120	150	90
Loulé IV <sup>NL</sup>	16 x 9 x 5	159 m <sup>2</sup>	132	108	54	84	120	150	90
Loulé II + III + IV <sup>NL</sup>	16 x 28 x 5	480 m <sup>2</sup>	500	168	105	280	400	450	320
ALCOUTIM — multifunctional room	16 x 17 x 5	289 m <sup>2</sup>	250	126	80	140	200	250	150
LOULÉ + ALCOUTIM — multifunctional room <sup>NL/1</sup>	— x — x 5	1096 m <sup>2</sup>	960	600	—	595	850	1100	650
TERRACE <sup>NL</sup>	7 x 52 x —	363 m <sup>2</sup>	—	—	—	175	250	400	190

Approximate dimensions/areas.

NL = with Natural Light. I INL = with Indirect Natural Light. I 1 = See floor plan for possible layouts.





# Auditorium

## SALGADOS PALACE & CONGRESS CENTER

★ ★ ★ ★ ★  
ALGARVE

Theatre I

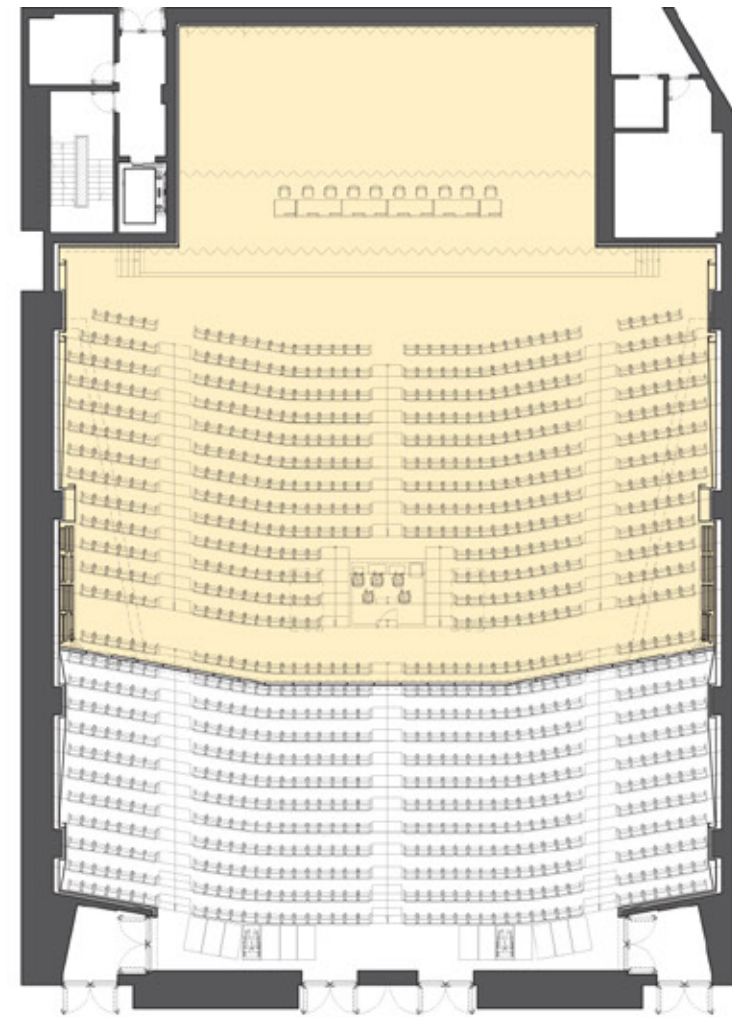

Theatre II

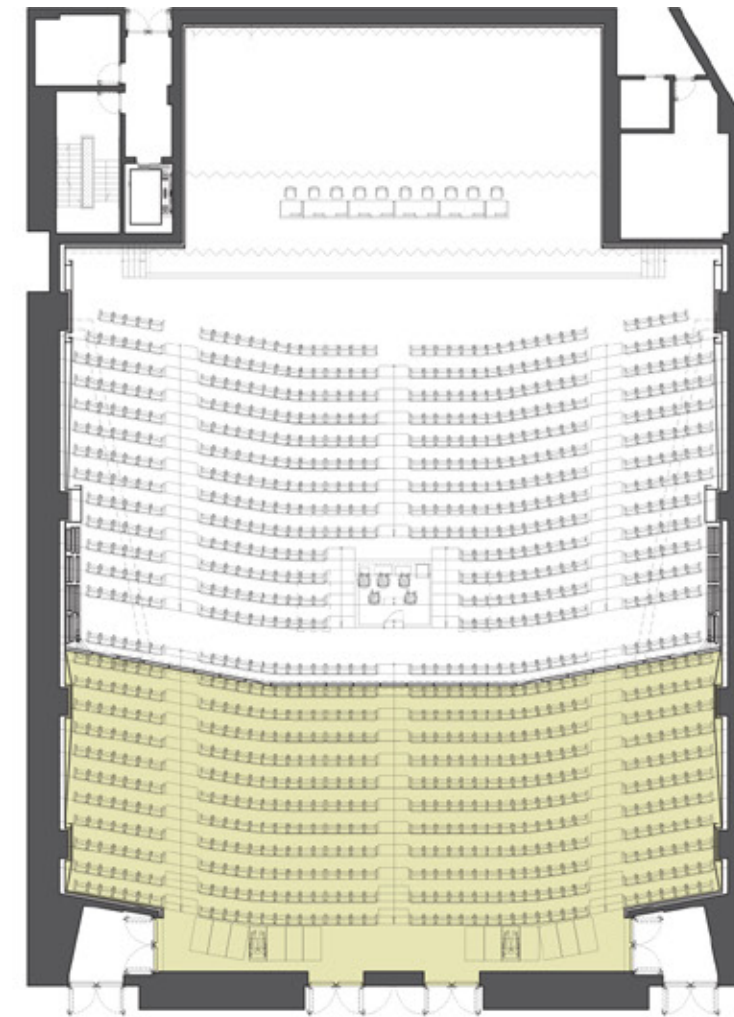

Theatre III

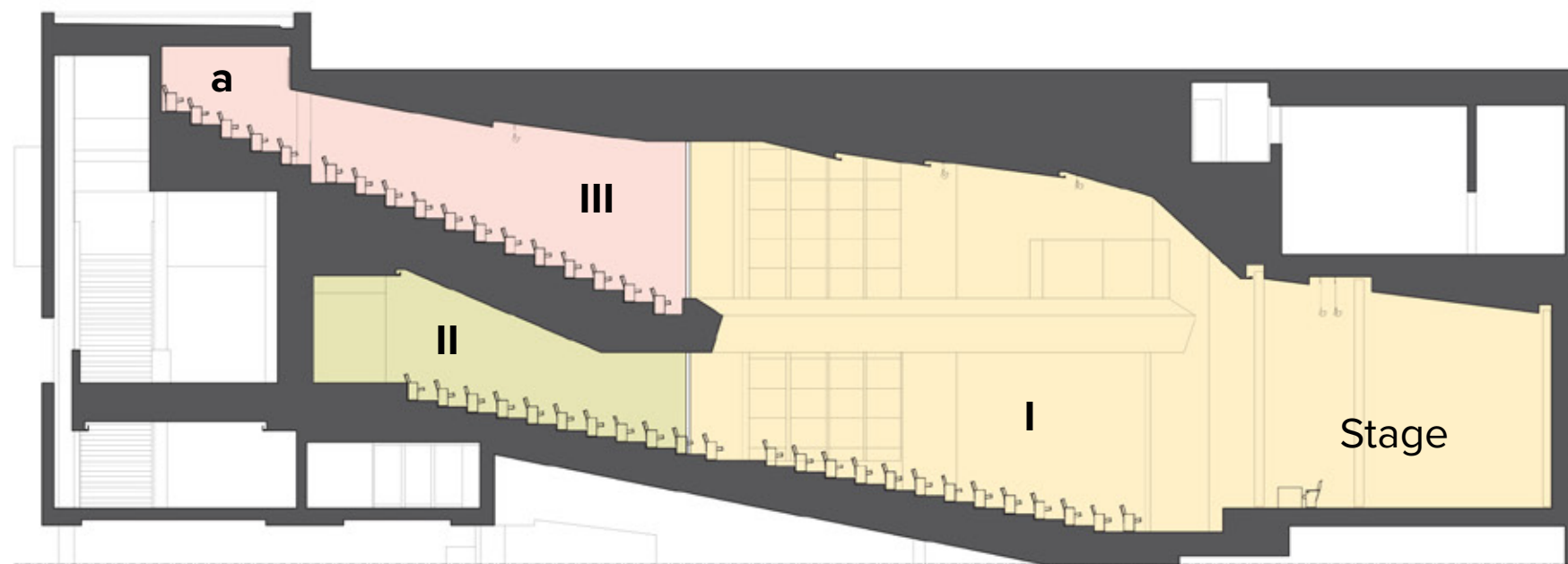
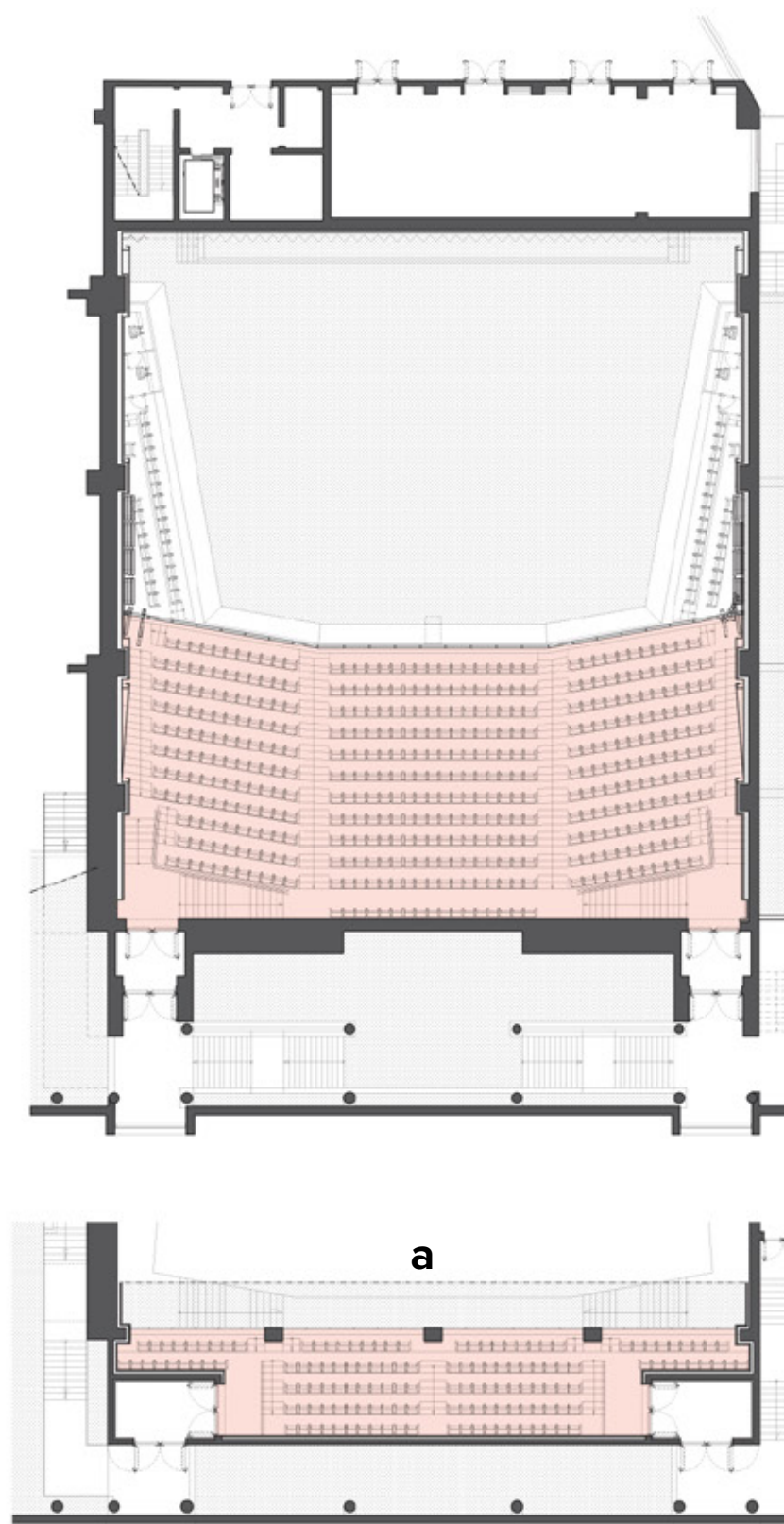

### ALGARVE AUDITORIUM

	SEATS	WHEELCHAIR SPACES
<b>TOTAL CAPACITY</b>	<b>1.650*</b>	<b>14</b>
<b>ALGARVE I</b>	538*	—
<b>ALGARVE II</b>	462	14
<b>ALGARVE III</b>	650	—
<b>ALGARVE I + II</b>	1.000*	14

\* 14 wheelchair spaces not considered



**ALGARVE**  
ALBUFEIRA - PORTUGAL



**[www.nauhotels.com](http://www.nauhotels.com)**

Leading Guest Happiness

 [facebook.com/nauhotels](https://facebook.com/nauhotels)

**#nauhotels**