

FLOOR ATLANTIC . CONGRESS CENTRE

AUDIOVISUAL EQUIPMENT INTEGRATED IN THE CONFERENCE ROOMS (against payment)

Built-in voice and audio sound system in all conference rooms

SCREENS:

- 4 Built-in screens 4 m x 3 m

LCD PROJECTORS:

- 4 Wireless WUXGA 3LCD Laser Projectors (6.000 lumens)

SUPPORT INFRASTRUCTURES

SERVICES AVAILABLE:

- 2 Portable screens 2,5 m x 2,5 m
- 2 Portable Projectors
- 8 Wireless handheld microphones
- 4 Wireless headset microphones
- 4 Wireless clip microphones
- WI-FI in public areas and meeting rooms
- Flip charts
- Laser pointers
- Remote control for curtains
- Reception facilities for groups
- Direct access for buses
- Digital signposting to guide delegates
- Exclusive area for secretarial services



ROOM	AREA sqm	DIMENSIONS m x m	HEIGHT m	THEATRE 	CLASSROOM 2 pax/table 	CABARET 6 pax/table 	'U' SHAPE 2 pax/table 	BANQUET set menu 	COCKTAIL with bistros
ATLANTIC FLOOR+FOYER	1029	10,7 m x 25,65 m 25 m x 30,2 m	4,2						
ATLANTIC I+II+III	755	25 m x 30,2 m	4,2						
ATLANTIC I	247	25 m x 9,9 m	4,2						
ATLANTIC II	263	25 m x 10,5 m	4,2						
ATLANTIC III	245	25 m x 9,8 m	4,2						
ATLANTIC I+1/2 II	378,5	125 m x 15 m	4,2						
ATLANTIC III+1/2 II	376,5	25 m x 14,9 m	4,2						
ATLANTIC I+II	510	25 m x 20,4 m	4,2						
ATLANTIC III+II	508	25 m x 20,3 m	4,2						
ATLANTIC FOYER	346	10,7 m x 25,65 m 4,7 m x 15,25 m	4,2						

FLOOR PACIFIC . CONGRESS CENTRE

AUDIOVISUAL EQUIPMENT INTEGRATED IN THE CONFERENCE ROOMS (against payment)

Built-in voice and audio sound system in 3 conference rooms

SCREENS:

- 5 Built-in screens 4 m x 3 m

LCD PROJECTORS:

- 5 Projectores laser sem fio WUXGA (6.000 lumens)

SUPPORT INFRASTRUCTURES SERVICES AVAILABLE:

- 2 Portable screens 2,5 m x 2,5 m
- 2 Portable Projectors
- 8 Wireless handheld microphones
- 4 Wireless headset microphones
- 4 Wireless clip microphones
- WI-FI in public areas and meeting rooms
- Flip charts
- Laser pointers
- Remote control for curtains
- Reception facilities for groups
- Digital signposting to guide delegates
- Exclusive area for secretarial services

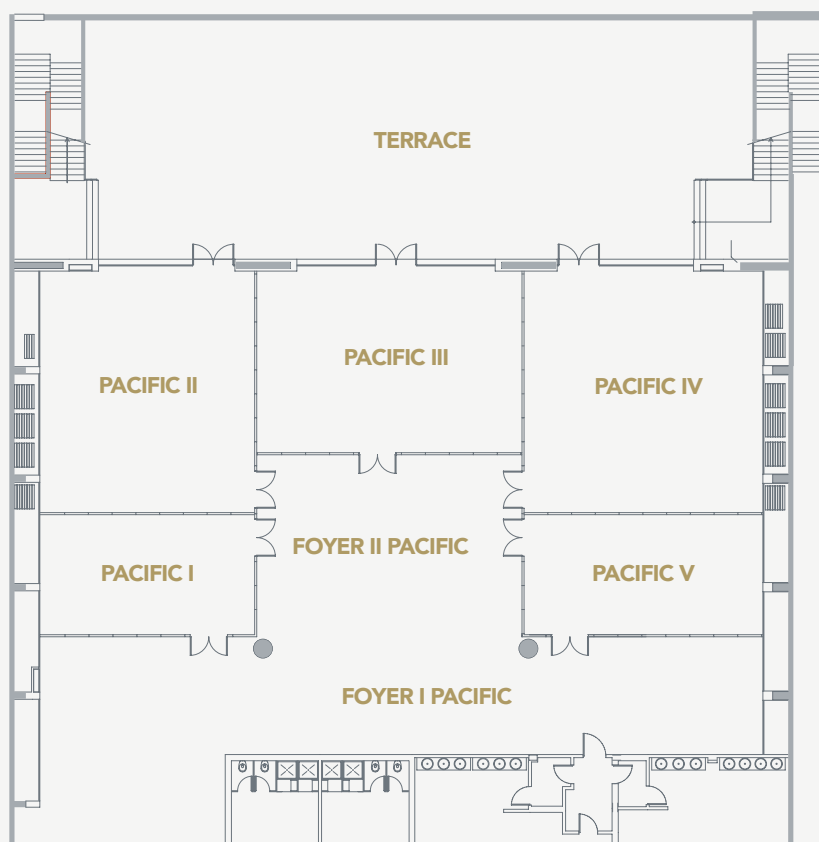

ROOM	AREA sqm	DIMENSIONS m x m	HEIGHT m	THEATRE ⌆⌆⌆⌆	CLASSROOM ⌆⌆⌆ 2 pax/table	CABARET ⌆ 6 pax/table	'U' SHAPE ⌆ 2 pax/table	BANQUET ⌆ set menu	COCKTAIL ⌆ with bistros
PACIFIC I	62	5,8m x 10,7m	4,2						
PACIFIC II	126	11,75m x 10,7m	4,2						
PACIFIC III	114,5	8,85m x 12,9m	4,2						
PACIFIC IV	132	11,75m x 11,25m	4,2						
PACIFIC V	66	5,8m x 11,25m	4,2						
FOYER I PACIFIC	199,5	5,7m x 35m	4,2						
FOYER II PACIFIC	114	8,8m x 12,95m	4,2						
PACIFIC FLOOR + FOYER I + II	819	23,4m x 35m	4,2						
PACIFIC FLOOR + FOYER II	619,5	17,7m x 35m	4,2						
PACIFIC I + II + III + FOYER II	416,5	17,55m x 23,6m	4,2						
PACIFIC III + IV + V + FOYER II	426,5	17,55m x 24,15m	4,2						
PACIFIC III + FOYER PACIFIC II	226	17,55m x 12,9m	4,2						
TERRAÇO PACIFIC	256	32m x 8m	4,2						
PACIFIC I + II	188	17,55m x 10,7m	4,2						
PACIFIC IV + V	198	17,55m x 11,25m	4,2						