

SOTAVENTO

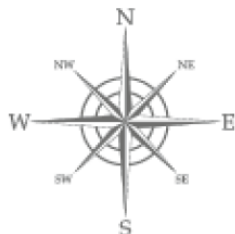

Características das Salas:

- Luz Natural
- Localização no 1º piso
- Ar-condicionado
- Serviço de internet wireless
- Equipadas com blackout, luzes, som, tela e projetor com comando remoto individual Philips
- Caixas técnicas (tomadas elétricas, telecomunicações, etc.)
- Portas com 1,60m de largura x 2m de altura
- Plataforma elevatória com acesso direto à sala, para colocação de equipamento de grandes dimensões (automóveis, maquinaria, etc.)

Room details:

- Natural daylight
- Located on the 1st floor
- Air-conditioning
- High speed wireless internet access
- Equipped with total blackouts, lights, sound system, screen and projector, with individual Philips remote control
- Technical boxes on the floors (electrical plug-ins, telecommunications, etc.)
- Entrance doors 1,60m wide x 2m high
- Elevator platform with direct access to meeting room, for large dimension equipment (automobiles, machinery, etc.)

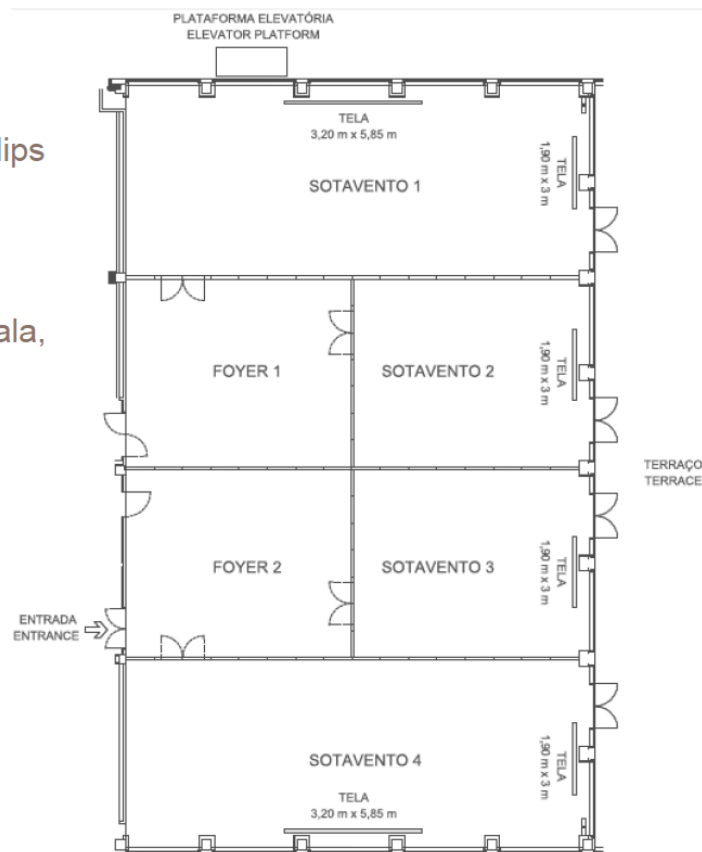

Salas Meeting Rooms	Área M ² Size M ²	Comp.xLarg. LengthxWidth	Altura Height	Banquete Banquet	Escola Classroom	Plateia Theatre	U-Aberto U-Shape	Cocktail	Boardroom Set Up
Sotavento	585	30 x 18	3,20	350	430	600	100	800	-
Sotavento 1	141	18 x 7	3,20	110	90	120	50	130	-
Sotavento 2	73	9 x 7	3,20	-	50	70	30	100	20
Sotavento 3	73	9 x 7	3,20	-	50	70	30	100	20
Sotavento 4	138	18 x 7	3,20	100	90	120	50	130	-
Sotavento 1+2+Foyer 1	292	18 x 15	3,20	230	200	260	60	400	-
Sotavento 2+3	149	15 x 9	3,20	100	50	160	40	150	-
Foyer 1	149	15 x 9	3,20	-	-	-	-	-	-
Foyer 2	74	9 x 7	3,20	-	-	-	-	-	-

Crowne Plaza Vilamoura - Algarve Hotel

Rua do Oceano Atlântico, 8125-478 Vilamoura | Tel: +351 289 381 600 | Fax: +351 289 381 652

E-mails: geral@cpvilamoura.com – reservations@cpvilamoura.com | Web: www.crowneplazavilamoura.com | GPS LAT 37° 04'21.91"N, LONG 8° 6'50'69"W