

## GRAND HYATT SEOUL

322 Sowol-ro, Yongsan-gu  
Seoul 04347, Korea

+82 2 797 1234 TELEPHONE

+82 2 798 6953 FAX

seoul.grand@hyatt.com

seoul.grand.hyatt.com

GRAND | HYATT™

### ACCOMMODATIONS

- 615 guest rooms including rooms with mountain and river view, Grand Executive Suite, Ambassador Suite, and Presidential Suite

#### All Accommodations Offer:

- Remote control televisions with satellite channels, DVD players and On-Demand movies
- Spacious work desk with enhanced lighting, two telephone lines, MP3 docking station, dataport, voice mail, high-speed wired and wireless Internet access
- Individually-controlled air-conditioning and heating
- Complimentary daily newspaper upon request
- In-room Mini Bar
- Comfortable private bathrooms
- Personal safe
- Electricity: 110 / 220V (transformers available)

### SERVICES & FACILITIES

- 24-hour room service
- Concierge desk
- 24-hour Duty Assistant Manager
- Business and Meeting Center
- Daily shuttle service to Itaewon and Myeongdong
- Travel service and rental car desk
- Daily laundry and dry cleaning services
- Currency exchange
- ATM available in the Lobby
- Safety-deposit boxes
- Gift shop / shopping arcades
- Flower shop
- Beauty salon and barber shop
- Covered valet parking
- Off-property catering available
- Multilingual staff
- Ice machines
- Grand Club™
- Wi-Fi / high speed Internet

### LOCATION

In the heart of South Korea's capital city, ten minutes from the city center, twenty minutes from the Samsung-dong business hub and five minutes from the Itaewon shopping district.

### DIRECTIONS

From Incheon International Airport: Exit car park and follow Incheon International Airport Expressway signs, leading to Olympic Expressway. Take the Expressway east towards the Olympic Stadium, following signs for Banpo Bridge. Cross the bridge and head towards City Hall. Turn right at Gyeongridan Rd. lights. Head up the hill and turn right at the top into Grand Hyatt Seoul.

### POINTS OF INTEREST

- Namsan Park and walking trails
- Itaewon shopping district
- Leeum, Samsung Museum of Art
- Dongdaemun Design Plaza (DDP)
- Dongdaemun Market
- Namdaemun Market
- Gyeongbok Palace
- Deoksu Palace
- Insadong, the street of culture
- Korean Furniture Museum
- Nasangol Hanok Village
- National Museum of Korea

### RESTAURANTS & BARS

A variety of international cuisines from European and Japanese are offered in the hotel's 12 restaurants and bars, each showcasing its own unique style and authenticity

- *Gallery* - Lounge café
- *Kauri* - Modern sushi bar
- *Steak House* - Premier grilled delicacies
- *Teppan* - International cuisine on a hot teppan griddle
- *Tenkai* - Japanese pub with izakaya style cuisine
- *The Paris Bar* - European classic bar
- *The Terrace* - International dining restaurant
- *The Deli* - Boutique bakery and gourmet specialty shop
- *J.J. Mahoney's* - Entertainment center
- *JJ Deli* - European casual bistro
- *Helicon* - Ultra-high class song bar
- *Poolside BBQ* - Seasonal barbeque buffet

### MEETING & EVENT SPACE

- The hotel's seven function rooms provide planners with a variety of venues for grand events to intimate business meetings with tailor-made set-ups for 20 to 2,000 guests
- All the function rooms provide up-to-the minute satellite technology, including high-speed Internet service with VPN solutions, satellite teleconferencing and simultaneous translation services
- Our creative team has a vast array of design and production resources at their disposal to transform concepts into reality
- Expansive, full-service Business and Meeting Center with four private computers equipped offices and ten meeting rooms seating 6 to 16 persons. Ideal for both formal and informal meetings and events, with full dining services

### RECREATIONAL FACILITIES

- Club Olympus Fitness Center, including 24-hour gymnasium for hotel guests, aerobic studios with group exercise classes, indoor, outdoor and children's swimming pools, men's and women's saunas with Korean body scrub services, tennis and squash courts, and ice skating rink (winter only)
- The Spa Grand Hyatt Seoul, including luxurious Spa Suites and treatment rooms



**GRAND HYATT SEOUL**

322 Sowol-ro, Yongsan-gu  
Seoul 04347, Korea

+82 2 797 1234 TELEPHONE

+82 2 798 6953 FAX

seoul.grand@hyatt.com

seoul.grand.hyatt.com



GRAND | HYATT™

**FLOOR PLAN**

*Lobby Level*

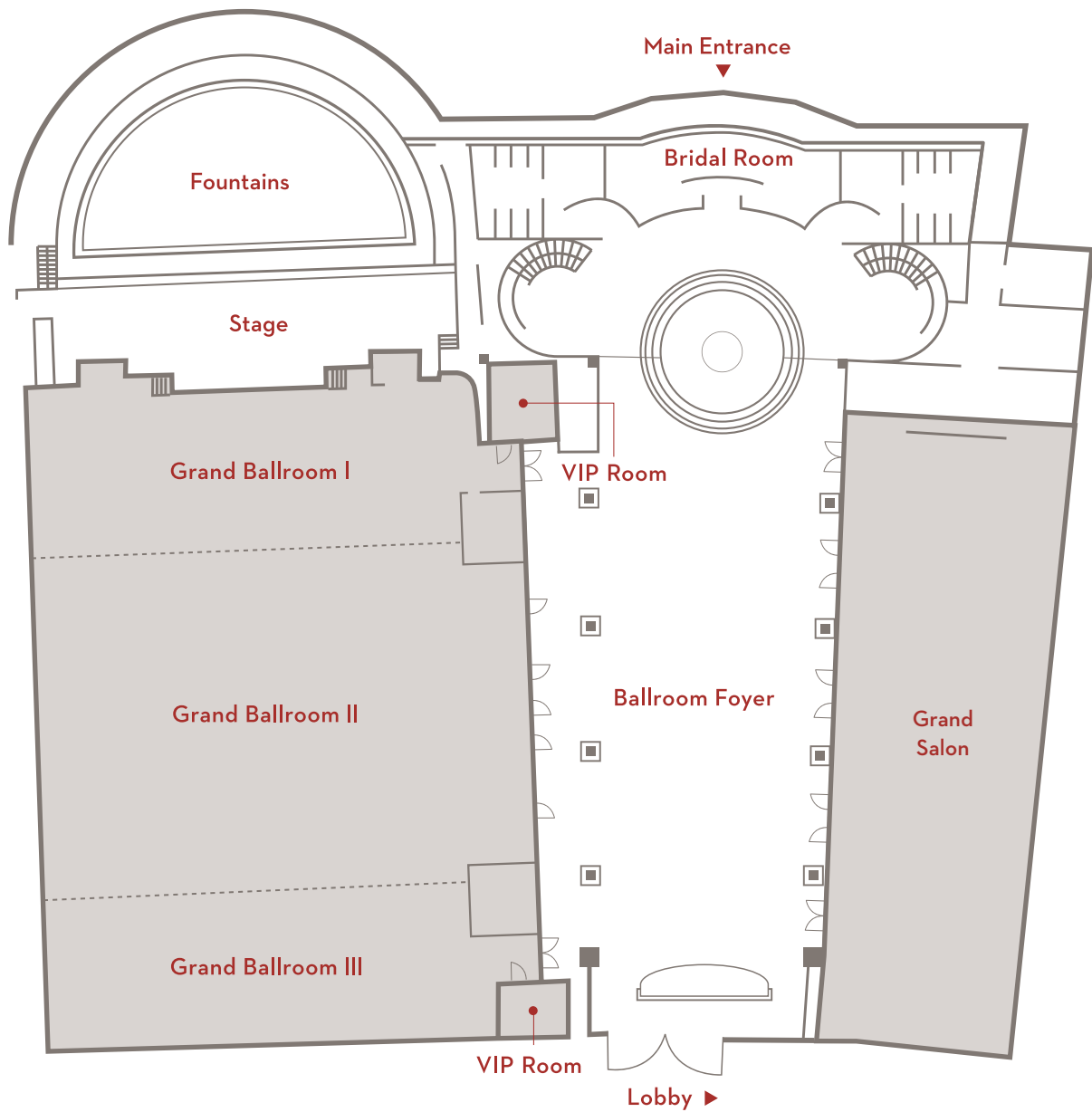

**GRAND HYATT SEOUL**

322 Sowol-ro, Yongsan-gu  
Seoul 04347, Korea

+82 2 797 1234 TELEPHONE

+82 2 798 6953 FAX

seoul.grand@hyatt.com

seoul.grand.hyatt.com



**GRAND | HYATT™**

**FLOOR PLAN**

*Second Level - Namsan Rooms*

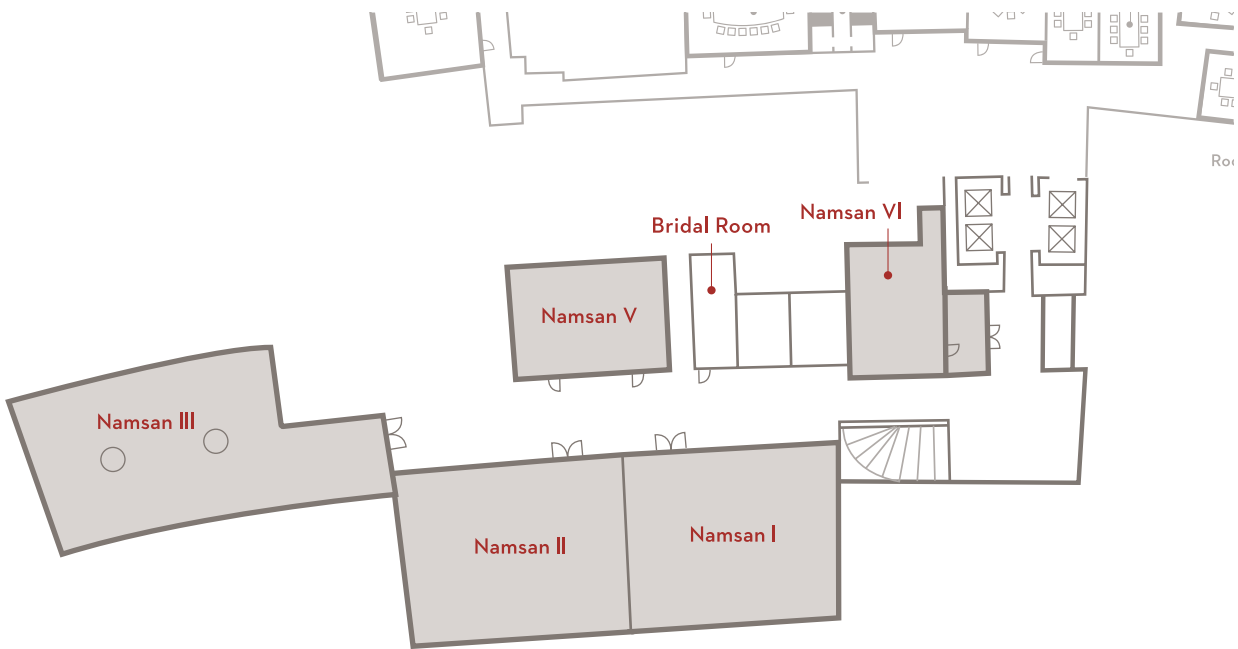

**FLOOR PLAN**

*Second Level - Business Center*

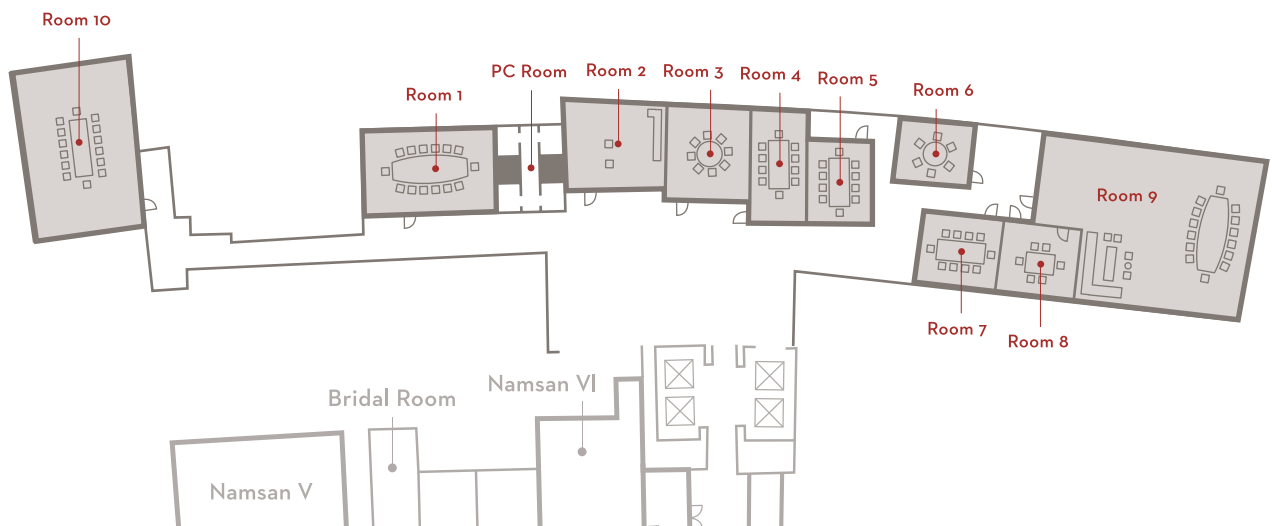

**GRAND HYATT SEOUL**

322 Sowol-ro, Yongsan-gu  
Seoul 04347, Korea

+82 2 797 1234 TELEPHONE

+82 2 798 6953 FAX

seoul.grand@hyatt.com

seoul.grand.hyatt.com

GRAND | HYATT™



**FLOOR PLAN**

Lower Lobby Level - Sansoo

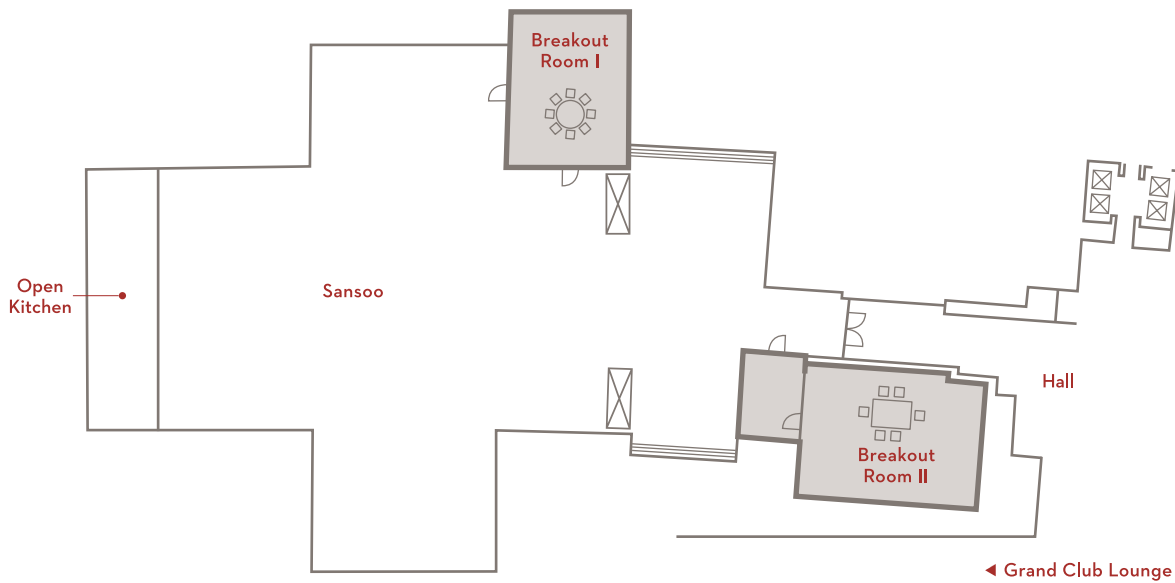

**FLOOR PLAN**

Garden Level

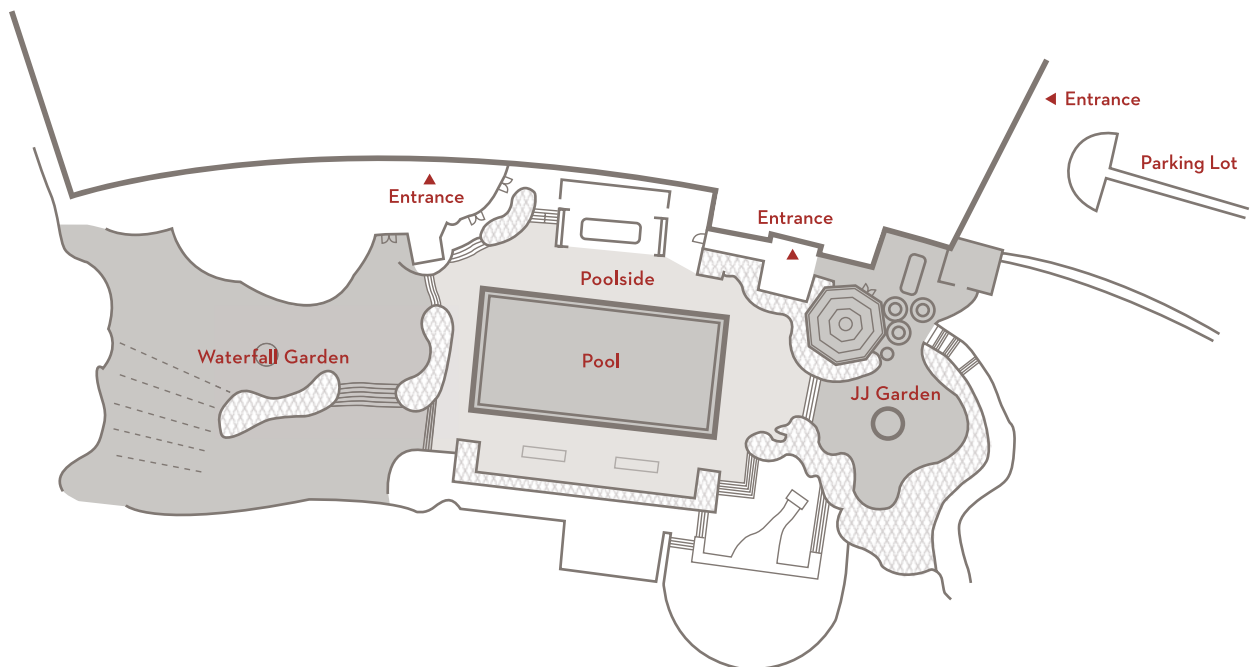



## GRAND HYATT SEOUL

322 Sowol-ro, Yongsan-gu  
Seoul 04347, Korea

+82 2 797 1234 TELEPHONE

+82 2 798 6953 FAX

seoul.grand@hyatt.com

seoul.grand.hyatt.com



GRAND | HYATT™

### ROOM DIMENSIONS AND CAPACITIES



ROOM NAME	ROOM DIMENSIONS L X W X H	SQ. FT. METERS	BANQUET	RECEPTION	THEATER	CLASSROOM	BOARDROOM	U-SQUARE	HOLLOW SQUARE	EXHIBIT (BOOTH: 3M X 2M X 2.5M)
GRAND BALLROOM I	39' x 93' x 19.7' 10.8m x 28.4m x 6m	3,255 305	200	300	200	200	100	80	100	(14)
GRAND BALLROOM II	73' x 93' x 19.7' 22.4m x 28.4m x 6m	6,789 635	400	500	600	400	200	180	200	(28)
GRAND BALLROOM III	31' x 93' x 19.7' 9.6m x 28.4m x 6m	2,883 273	200	200	300	200	100	80	100	(14)
GRAND BALLROOM I + II + III	140' x 93' x 19.7' 42.7m x 28.4m x 6m	12,927 1213	950	1500	1200	950	400	340	400	(56)
GRAND SALON	108' x 42' x 19.7' 32.9m x 12.9m x 5.8m	4,536 423	300	300	300	250	150	120	150	(22)
BALLROOM FOYER	137' x 42' x 19' 41.9m x 12.7m x 5.8m	5,754 531	150	300	—	—	—	—	—	(22)
GRAND BALLROOM + FOYER + GRAND SALON	— —	23,217 2167	1400	2000	1500	1200	550	460	550	(100)

### ROOM DIMENSIONS AND CAPACITIES



ROOM NAME	ROOM DIMENSIONS L X W X H	SQ. FT. METERS	BANQUET	RECEPTION	THEATER	CLASSROOM	BOARDROOM	U-SQUARE	HOLLOW SQUARE
SANSOO	55.8' x 32.8' x 11.5' 17m x 10m x 3.5m	1,850 171.9	80	100	120	63	24	25	26
Breakout Room I	14' x 20' x 11.5' 4.25m x 6.11m x 3.5m	280 26	7	—	—	—	—	—	—
Breakout Room II	19' x 14' x 11.5' 5.84m x 4.2m x 3.5m	264 24.5	—	—	—	—	14	—	—

### ROOM DIMENSIONS AND CAPACITIES



ROOM NAME	ROOM DIMENSIONS L X W X H	SQ. FT. METERS	BANQUET	RECEPTION	THEATER	CLASSROOM	BOARDROOM	U-SQUARE	HOLLOW SQUARE
WATERFALL GARDEN	—	11,625 1,080	250	300	—	—	—	—	—
POOLSIDE	—	3,767 350	250	300	—	—	—	—	—
JJ GARDEN	—	3,864 359	120	150	—	—	—	—	—

## GRAND HYATT SEOUL

322 Sowol-ro, Yongsan-gu  
Seoul 04347, Korea

+82 2 797 1234 TELEPHONE

+82 2 798 6953 FAX

seoul.grand@hyatt.com

seoul.grand.hyatt.com



GRAND | HYATT™

### ROOM DIMENSIONS AND CAPACITIES



ROOM NAME	ROOM DIMENSIONS L X W X H	SQ. FT. METERS	BANQUET	RECEPTION	THEATER	CLASSROOM	BOARDROOM	U-SQUARE	HOLLOW SQUARE
NAMSAN I	49' x 39' x 11.5' 15m x 11.9m x 3.5m	1,911 178.8	90	100	112	84	36	32	38
NAMSAN II	49' x 39' x 11.5' 15m x 11.9m x 3.5m	1,911 178.8	90	100	112	84	36	32	38
NAMSAN I + II	98' x 39' x 11.5' 30m x 11.9m x 3.5m	3,822 357.6	200	220	240	180	72	72	84
NAMSAN III	72' x 42.9' x 11.5' 22m x 13m x 3.5m	3,849 357.9	170	220	200	150	72	72	84
NAMSAN V	39' x 29.6' x 11' 12m x 9m x 3.4m	1,154 108.8	50	60	70	50	24	28	36
NAMSAN VI	34' x 19.7' x 13' 10.5m x 6m x 4m	670 63	40	50	50	40	20	21	24

### ROOM DIMENSIONS AND CAPACITIES



ROOM NAME	ROOM DIMENSIONS L X W X H	SQ. FT. METERS	BANQUET	RECEPTION	THEATER	CLASSROOM	BOARDROOM	U-SQUARE	HOLLOW SQUARE
ROOM 1	24.7' x 16.57' x 9.84' 7.53m x 5.05m x 3m	409.31 38.03	—	—	—	—	14	—	—
ROOM 2	16.5' x 14.44' x 8.46' 5.03m x 4.4m x 2.58m	238.23 22.13	—	—	—	—	6	—	—
ROOM 3	15.75' x 12.4' x 8.53 4.8m x 3.78m x 2.6m	195.3 18.14	—	—	—	—	8	—	—
ROOM 4	20.93' x 13.12' x 8.46' 6.38m x 4m x 2.58m	274.69 25.52	—	—	—	—	12	—	—
ROOM 5	17.06' x 13.12' x 8.46' 5.2m x 4m x 2.58m	218.29 20.28	—	—	—	—	10	—	—
ROOM 6	14.76' x 11.15' x 8.69' 4.5m x 3.4m x 2.65m	164.69 25.3	—	—	—	—	6	—	—
ROOM 7	17.39' x 11.48' x 8.69' 5.3m x 3.5m x 2.65m	199.67 18.55	—	—	—	—	10	—	—
ROOM 8	13.29' x 11.48' x 8.69' 4.05m x 3.5m x 2.65m	155.58 14.18	—	—	—	—	6	—	—
ROOM 9	39.53' x 26.9' x 9.19' 12.05m x 8.2m x 2.8m	1,063.58 98.81	—	—	—	—	16	—	—
ROOM 10	27.89' x 14.76' x 11.15' 8.5m x 4.5m x 3.4m	411.72 38.25	—	—	—	—	14	—	—